

DETEX EAX-500 Exit Alarm

Battery Powered Door or Wall Mounted

- Use on emergency exit and restricted doors
- Battery-powered alarm for secured doors
- Alarm sounds when unauthorized exit occurs
- Thinner Shape & smaller size for versatility
- Ideal for quick & easy installations
- Secure, tamper resistant housing
- Door or wall mount
- 9VDC battery operated with Low Battery Alert
- Key required to reset alarm
- Can only be silenced with proper key

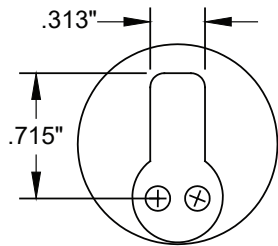

Mortise Cylinder dimensions approximate



Shown with mortise cylinder (cylinder sold separately)

See Below

Delta Mortise Cylinder Kit
(includes 700 Cam)



Part #: EAX 500

Dimensions Front and Side View

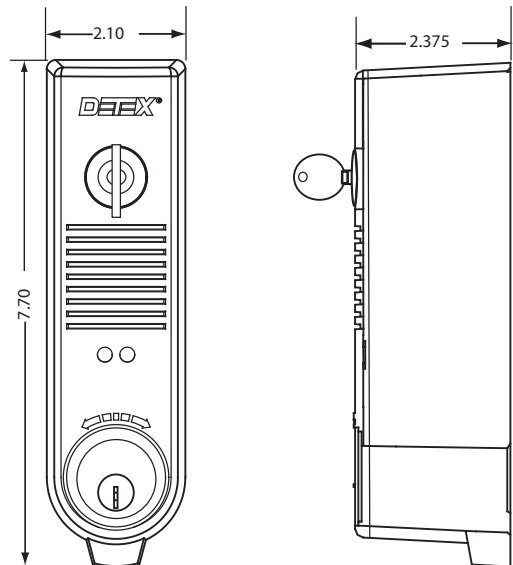

Mounting Diagram

